

# N86C

**COIL-FED PNEUMATIC NAILERS**  
**CLAVADORAS NEUMÁTICAS ALIMENTADAS POR ROLLO**  
**CLOUEURS PNEUMATIQUES À ENROULEMENT**

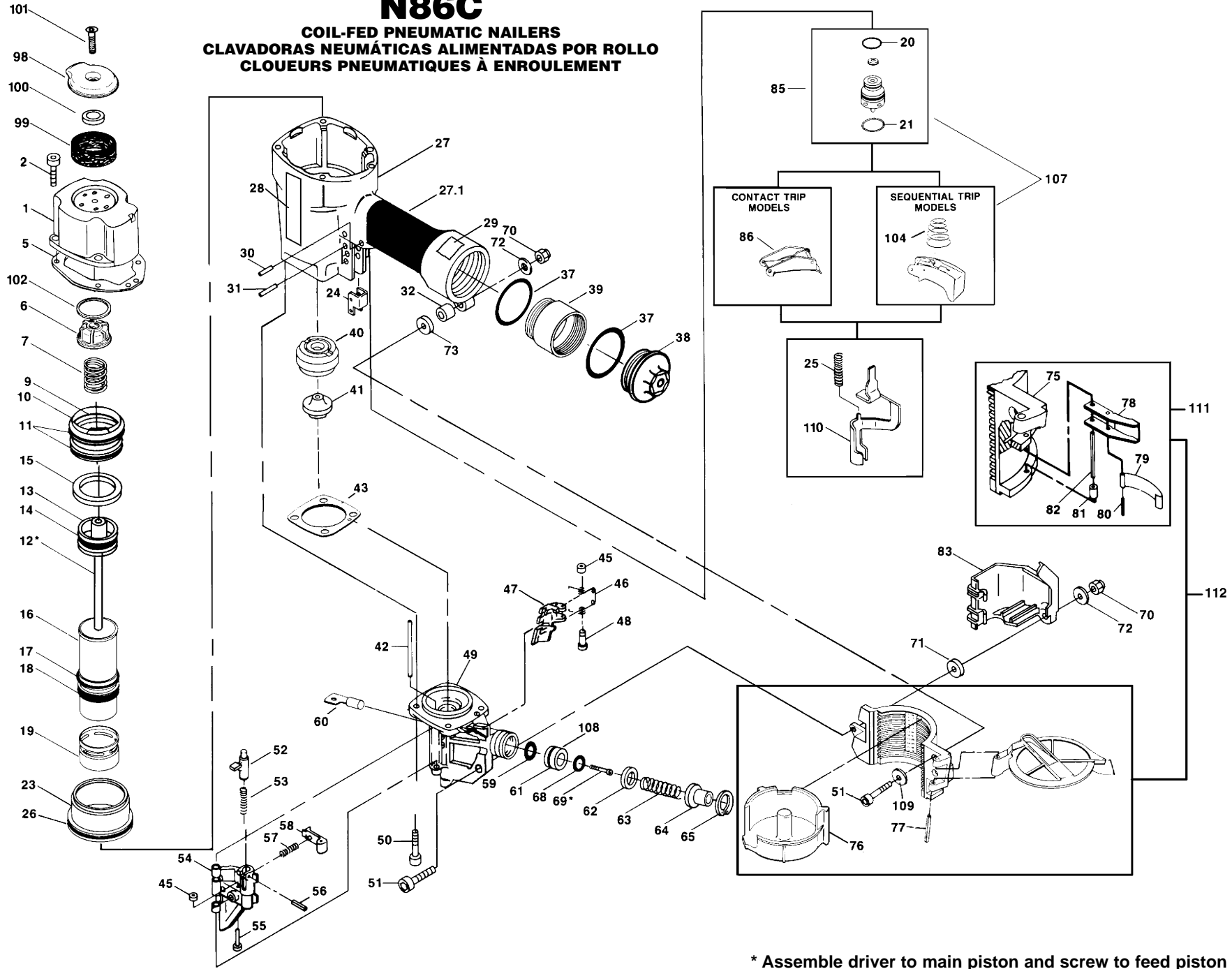

IP1066-1REVF  
 TO BE USED WITH IP1066-2 AND 102776 OPERATION & MAINTENANCE MANUAL.

\* Assemble driver to main piston and screw to feed piston rod with Loctite #271, available as part 851325 Loctite 271 Packet.  
 \*\* Assemble screw to cylinder cap with Loctite #242, available as part 851385 Loctite 242 Packet.